

**imageRUNNER**  
iR1750i/1740i/1730i/1730

**Canon**

Delighting You Always

A  
**PERFECT COMPLEMENT**  
TO YOUR PRINT FLEET



Business **Can** be simple

# The new imageRUNNER 1700 SERIES

## - your multifunctional office companion.

The imageRUNNER 1700 series is the perfect fit for your office document needs. It is a printer, a color scanner, a fax machine all in one powerful and compact device. With exceptional print and scanning speeds of up to 30/40/50 pages per minute, the imageRUNNER 1700 series boasts both velocity and versatility.

So if you are looking for a multifunction device to match the pace of your productivity, look no further than the imageRUNNER 1700 series.



**Compact yet powerful**, the imageRUNNER 1700 series is equipped with many features usually available on the bigger A3 multifunction devices. It includes built-in Ethernet for network capabilities, USB 2.0 connectivity for direct scan-to and print-from memory media, as well as card-based authentication support for enhanced security.



**Easy replacement of consumables** minimizes downtime so you can get right back to printing quickly. The result is higher productivity and return on investment, with lower environmental impact and total cost of ownership.



**Large, intuitive 5.7" touch screen LCD** offers enhanced usability from the first touch. The high-contrast monochrome screen hosts a user-friendly interface that lets you switch between the menus and functions effortlessly. The tilt-table panel ensures a clear sight of the control from a wide range of viewing angles.



**High paper capacity** starts at 650 sheets default, upgradable to a maximum of 2,300 sheets without increasing device footprint. This ensures an uninterrupted paper flow for the most demanding of print jobs.



# Multiply your productivity with **COPY** features.



## Standard Automatic Document Feeder

Every imageRUNNER 1700 series device is equipped with an automatic document feeder, making it more convenient and productive when copying multiple document pages.

## Finishing Features

The imageRUNNER 1700 series comes standard with the ability to group or collate your paper output. With an optional upgrade Stapler Finisher-H1, you can also automatically staple grouped documents or have the paper positions for each set slightly offset.



## Enhanced Auto-Magnification

imageRUNNER 1700 series offers a wide zoom ratio range of 25% - 400%. Enlarge or reduce contents to fit your desired paper size automatically at the touch of a button. This helps to eliminate guesswork while promoting cost savings.

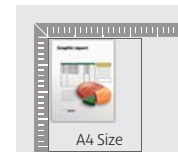

Original



Contents fit to page

## Identification Card Copy

Making copies of ID cards is easy when you use the ID Card Copy function. Both sides of the card will be scanned before they are printed on a single side of the paper.

### 01. Scan front of card



### 02. Scan back of card



### 03. Print



## Combine Multiple Originals onto One Sheet

This feature allows you to automatically reduce and repaginate multiple-page originals and bound originals to fit on a sheet of paper. It significantly reduces the number of pages used and filing space, delivering cost efficiency.

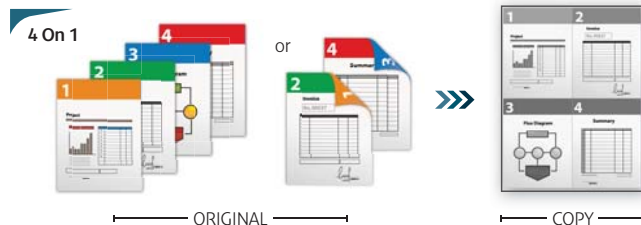

Make a powerful impression with

**PRINT** features.



### Duplex Printing

Duplex printing is available as default, so you can perform two-sided printing on your imageRUNNER and reduce paper costs by as much as 50%.



*Print two pages on a single piece of paper to save precious resources*

### Integrated Network Printing

The new imageRUNNER 1700 series can be seamlessly connected to your office network as a network printer. With support for IPv6, these devices are also ready to meet your future network infrastructure requirements.



*Standard network printing capability*

### Convenient Direct USB Memory Printing

With standard USB input, you can walk up to the device and print JPEG and TIFF files with your USB memory media on the spot.

### Enhanced Digital Print

The new imageRUNNER 1700 series features a standard print capability of 1200 x 1200 dpi with Canon's innovative Ultra Fast Rendering II LT (UFR II LT) printing technology. It is an ideal blend of speed and simplicity for professional looking documents. Optional support for PCL5e/6 and PostScript are also available.

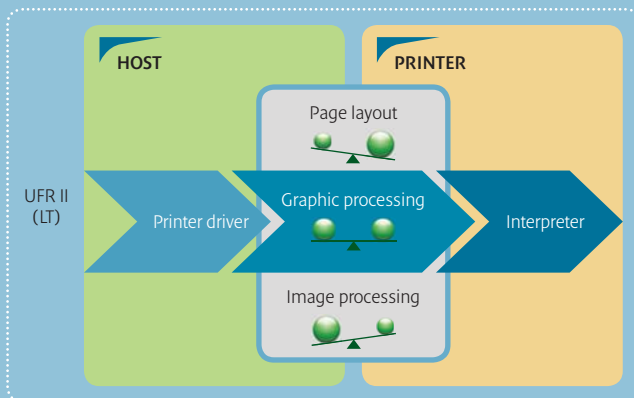

# Communicate confidently with NETWORK & SCAN features.



## Color Network ScanGear

With Color Network ScanGear, you can easily edit or modify scanned images at your own workstation and create crisp, clear, and detailed colored images by utilizing the network in your office. There is no need for standalone scanners or dedicate a PC to a scanner, saving precious time and resources.

## Distribute anywhere with Color Send

Sending of documents to your desired destinations can now be performed in a single operation. Just scan the originals and transmit them electronically to email addresses, shared folders, desktop PCs or faxes\*\*, and in various file formats such as PDF, JPEG and TIFF.

\* Color Send is standard for imageRUNNER 1730i/1740i/1750i; imageRunner1730 requires optional upgrade for this feature.

\*\* Installation of optional fax board is required.



## PDF High Compression Mode

Canon's innovative PDF High Compression Mode enables you to compress the file size of color images to approximately 1/10th the size of the original size while maintaining image quality.

## Searchable PDF

With the optional Searchable PDF Kit, you can create a Searchable PDF by enabling a scanned image to be text searchable. This reduces the time taken to search for keywords, especially within lengthy documents.

## Color Send with High-Compression Mode "PDF (Compact)"

Original: 11" x 17" Hard-copy, Color Graphic with Text



PDF FILE  
FORMAT

300 dpi Color Scan  
File Size: 7,561 KB



CANON'S PDF  
(COMPACT)

300 dpi Color Scan  
File Size: 353 KB



PDF FILE  
FORMAT

300 dpi B/W Scan  
File Size: 768 KB

High-quality Image Output  
Minimal File Size

## Scan and store directly to USB memory media

The new imageRUNNER 1700 series offers a new level of convenience with direct scan to USB memory media. You can convert paper documents to PDF, JPEG or TIFF formats and save them directly into a USB memory media.

# FAX feature.

## Add fax functionality with Super G3 Fax Technology

Send and receive fax messages with the optional Super G3 Fax technology by installing the optional fax board. The fast speed dramatically reduces your telephone charges, and is ideal for sending multiple pages using the one-touch (up to 200 one-touch dials) or group dialing functions.

## Fax Forwarding

You will never miss important faxes with Fax Forwarding. Incoming faxes can be configured to route automatically to your desired location.



# SECURE DEVICE MANAGEMENT

## Remote User Interface and eMaintenance

The inbuilt Remote UI (Remote User Interface) enables administrators to access machine functions and settings from a web browser on a computer. And with eMaintenance, administrators can keep track of consumables, device usage and reduce tedious administrative work such as manual meter reading and billing verifications automatically. All these translate to lower downtime and higher productivity.

*\* eMaintenance works with most Canon copiers, printers and multifunction devices.  
For more information on supported models, please contact Canon.*

## Device Authentication, usage accountability and secure printing solutions

Paired with uniFLOW solution, you can have greater control and management of the imageRUNNER 1700 series.

### Print Management

Track print activities on the device, and generate reports for easy viewing and analysis.

### Card Authentication

You can control access and prevent unauthorized users from using the device. Only users with a valid ID can access the device.

### Secure Print and My-Print-Anywhere

This unique feature requires users to be physically present at the device to collect their output from any uniFLOW enabled device in the organization, for security and user convenience.

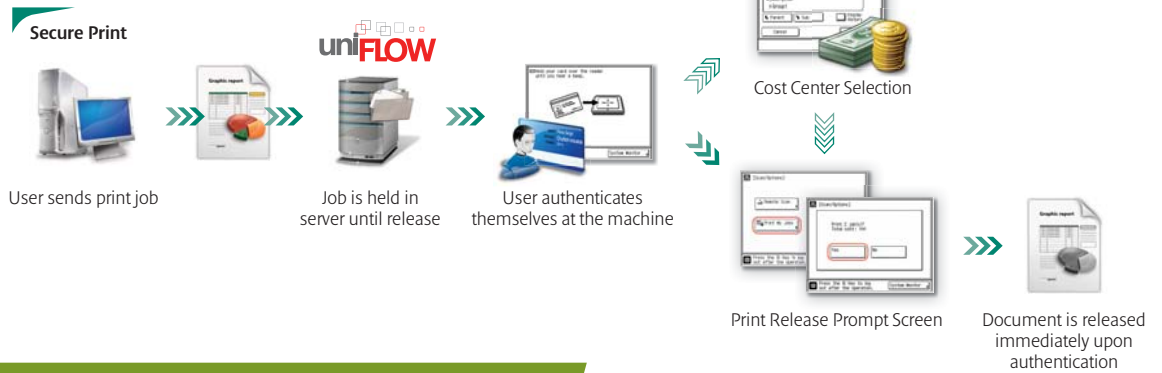

## A GREEN ENVIRONMENT

Canon designs multifunction devices with the environment in mind, aiming to reduce energy consumption when in use and ensuring ease and comfort of operation.

### Energy Conservation

With Canon's RAPID Fusing System™, imageRUNNERS are ready to print instantly, reduce high energy consumption and keep costs at a minimum. imageRUNNERS are certified as international ENERGY STAR® compliant.

### Compliance with EU directive on RoHS (Restriction on Hazardous Substance)

At Canon, non-hazardous materials and green materials are used. As such you can be assured that with Canon products, your business and well-being are taken care of.



**SPECIFICATION Canon imageRUNNER 1750i/1740i/1730i/1730**

Type	Desktop	
Resolution for Reading	600 dpi × 600 dpi	
Resolution for Writing	Copy: 600 dpi × 600 dpi Print: 1200 dpi × 1200 dpi	
Paper Weight	Paper Drawers 1, 3, and 4	64 g/m <sup>2</sup> to 105 g/m <sup>2</sup>
	Paper Drawer 2	64 g/m <sup>2</sup> to 105 g/m <sup>2</sup>
	Stack Bypass	64 g/m <sup>2</sup> to 128 g/m <sup>2</sup>
	Acceptable Originals	Sheet, Book, 3-dimensional objects (Up to approx. 30 mm or 2 kg)
Maximum Original Size	A4	
Paper Sizes	Paper Drawers 1, 3, and 4	A4, A5, B5
	Paper Drawer 2	A4, A5, B5, Envelopes*1 (No.10 (COM10), ISO-B5, Monarch, ISO-C5, DL)
	Standard size	A4, A5, B5
	Free size	99 mm to 216 mm × 140 mm to 356 mm Envelopes (No.10 (COM10), ISO-B5, Monarch, ISO-C5, DL)
Stack Bypass	Free size: 99 mm to 216 mm × 140 mm to 356 mm Envelopes (No.10 (COM10), ISO-B5, Monarch, ISO-C5, DL)	
Warm-Up Time	30 seconds or less	
First Copy Time	5.0 seconds or less (A4, direct, Paper Drawer 1)	
Copy Speed (Sheets per minute) (Except when paper is fed from the stack bypass)	imageRUNNER 1750i	A4→50, A5→25, B5→25
	imageRUNNER 1740i	A4→40, A5→25, B5→25
	imageRUNNER 1730i/1730	A4→30, A5→25, B5→25
Paper Feeding System	Paper Drawers 1, 3, and 4	550 sheets (80 g/m <sup>2</sup> )
	Paper Drawer 2	550 sheets (80 g/m <sup>2</sup> ) 50 envelopes (or 30 mm or less in height)*1
	Stack Bypass	100 sheets (80 g/m <sup>2</sup> )
	Multiple Copies	999 sheets
Memory	imageRUNNER 1750i/1740i/1730i	512 MB
	imageRUNNER 1730	256 MB
	OS Compatibility	Windows XP Professional/Home Edition, Windows 2000, Windows Server 2003, Windows Vista, Windows Server 2008, Windows 7
Power Source	220 - 240 V AC, 50/60 Hz, 5.0 A	
Max Power Consumption	1.6 kW or less	
Dimensions (W × D × H)	560 mm × 500 mm × 633 mm (with the feeder)	
Installation Space (W × D)	941 mm × 960 mm (with no optional equipment attached)	
	1,276 mm × 960 mm (with the optional Stapler Finisher-H1 attached)	
Weight	Approx. 44.3 kg	
Toner Yield (A4, 6% coverage)	Approx. 15,100 sheets	
Drum Yield	imageRUNNER 1750i	Approx. 112,000 sheets
	imageRUNNER 1740i	Approx. 97,000 sheets
	imageRUNNER 1730i/1730	Approx. 89,000 sheets

\*1 The optional Envelope Cassette-D1 is required.



Delighting You Always

**SOUTH & SOUTHEAST ASIA REGIONAL HEADQUARTERS**

Canon Singapore Pte. Ltd.  
1 HarbourFront Avenue #04-01, Keppel Bay Tower, Singapore 098632  
Tel: +65-6799 8888 | Fax: +65-6799 8882  
www.canon-asia.com  
www.canon.com.sg

**CANON SALES SUBSIDIARIES & BUSINESS PARTNERS**
**Afghanistan:**

Megaplus Afghanistan Limited  
House No. 233, Street No. 4,  
Charagh Ali, Qilla-e-Fatehullah,  
Kabul, Afghanistan  
Tel: 93-700 228 832 /  
93-700 979 511  
Fax: 93-202 201 259  
Email: info@megaplus.com.af

**Bangladesh:**

Flora Limited  
Adamjee Court Annex-2 (4<sup>th</sup> Floor)  
119-120 Motijheel Commercial Area  
Dhaka 1000 Bangladesh  
Tel: 880-2-716-2742-46 / 225  
Fax: 880-2-955-0030  
www.floralimited.com

**Brunei:**

Interhouse Company  
No. 5-7 Bunut Jaya Complex  
Spq 574 Jalan Tutong BF1320  
P.O. Box 423, Seri Complex  
Bandar Seri Begawan BA 1779  
Brunei Darussalam  
Tel: 673-2-653-001  
Fax: 673-2-653-003

**Cambodia:**

Royal Cambodia Co., Ltd  
#437 Preah Monivong Blvd  
Phnom Penh  
Kingdom of Cambodia  
Tel: 855-23-428955  
Fax: 855-23-722961

**Hong Kong:**

Canon Hongkong Co. Ltd  
19F, The Metropolis Tower  
10 Metropolis Drive  
Hung Hom, Hong Kong  
Tel: 852-3191-2388  
Fax: 852-2369-3800  
www.canon.com.hk

**India:**

Canon India Private Limited  
7<sup>th</sup> Floor, Tower B, Building #5  
DLF Cyber Terraces, DLF Phase-3  
Gurgaon - 122002  
Haryana, India  
Tel: 91-124-416 0000  
Fax: 91-124-416 0011  
www.canon.co.in

**Indonesia:**

PT Samafitro  
Jalan Ir. H Juanda No.8  
Jakarta 10120, Indonesia  
Tel: 62-21-345 8989  
Fax: 62-21-345 6699  
www.samafitro.co.id

**Malaysia:**

Canon Marketing (Malaysia) Sdn Bhd  
Block D, Peremba Square  
Saujana Resort Section U2,  
40150 Shah Alam  
Selangor Darul Ehsan, Malaysia  
Tel: 60-3-7844 6000 / 7845 0055  
Fax: 60-3-7844 6196 / 6198  
www.canon.com.my

**Maldives:**

Simdi Company Pvt Ltd.  
G.Manaam Building,  
2/1 Neeloafaru Magu,  
Male' 20-129, Maldives  
Tel: 960-333 4421  
Fax: 960-333 4424

**Myanmar:**

Myanmar Golden Rock International Co., Ltd  
Level 6, FJV Commercial Centre  
No: 422-426, Strand Road  
Botataung Township  
Yangon, Myanmar  
Tel: 95-1-202092 to 96  
Fax: 95-1-202079  
Email: sales@mgr.com.mm

**Nepal:**

International Electronics Concern (P) Ltd  
Kha 14, 1<sup>st</sup> Floor  
Haratibhawan Putalisadak  
Ramshah Path, Kathmandu, Nepal  
P.O. Box 12588  
Tel: 977-1-442 1991  
Fax: 977-1-442 1909

**Pakistan:**

Shirazi Trading Company (Pvt.) Ltd  
8<sup>th</sup> Floor, Adamjee House  
I.I. Chundrigar Road  
Karachi 74000 Pakistan  
Tel: 92-21-3241 (7659), (7737) or (7746)  
Fax: 92-21-(3241 7747), (3242 0417) or  
(3242 0418)  
www.shirazitradings.com.pk

**Philippines:**

Canon Marketing (Philippines), Inc.  
Ground Floor Commerce and Industry Plaza  
Campus Ave. Cor. Park Ave., McKinley Hill  
Fort Bonifacio, Taguig City  
Tel: 632-884-9000  
Fax: 632-556-1456  
www.canon.com.ph

**Sri Lanka:**

Metropolitan Office (Pvt) Ltd  
12, Magazine Road Colombo 08  
Sri Lanka  
Tel: 94-11-470 0200  
Fax: 94-11-470 0267

**Thailand:**

Canon Marketing (Thailand) Co. Ltd  
10<sup>th</sup> Floor Bangkok City Tower  
179/34-45 South Sathorn Road  
Bangkok 10120  
Tel: 66-2-344 9999  
Fax: 66-2-344 9960  
www.canon.co.th

**Vietnam:**

Canon Singapore Pte Ltd  
Ho Chi Minh City Representative Office  
Floor 6, Saigon Centre Building  
65 Le Loi, Ben Nghe Ward, District 1  
Ho Chi Minh City, Vietnam  
Tel: 848-3820 0466  
Fax: 848-3820 0477

**Canon Singapore Pte Ltd**

Hanoi Representative Office  
CharmVit Building, 11<sup>th</sup> Floor  
117 Tran Duy Hung, Cau Giay District  
Hanoi, Vietnam  
Tel: 844-3771 1677  
Fax: 844-3771 1678  
www.canon.com.vn

This document is for information purpose only. The contents are subject to change without notice.

Product options, name and availability may vary by regions. We expressly disclaim any liability or contractual obligations with respect to this document.

Canon, imageRUNNER, imageRUNNER ADVANCE, imageCHIP, RAPID Fusing System, MEAP, eMaintenance, Business can be simple and get Smart get genuine are trademarks of Canon Inc. and/or its affiliates. Other names may be the trademarks of their respective owners.

uniFLOW is an independent party software distributed by Canon Singapore Pte. Ltd.

0161W387 © 2011 Canon Singapore Pte. Ltd. All rights reserved. Printed in Singapore.